

SAFE-T-PULL™ Original

User Maintenance Guide

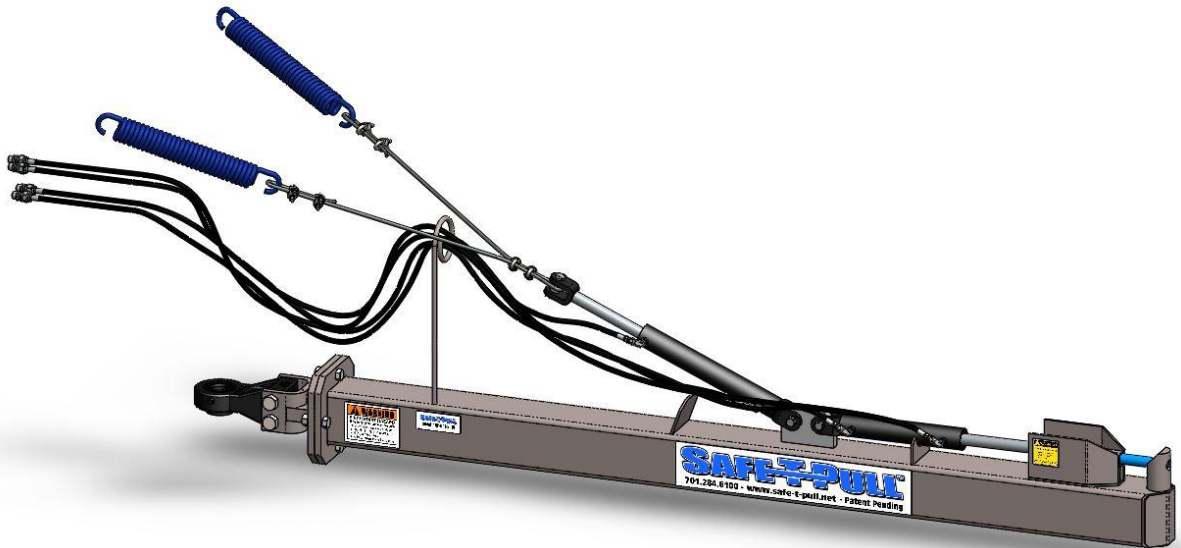

Safe-T-Pull Inc.

Pre-Operation Maintenance

Before every operation of your Safe-T-Pull ORIGINAL an inspection and pre-operation maintenance should be done to ensure all components are in operating order:

1. Check hydraulic fluid in the pulling vehicle to make sure levels are adequate.
2. Check hydraulic hoses for cuts, cracks, pressure bubbles, or other damage.
NOTE: Steel braiding should NEVER be visible
3. Check hydraulic fittings for dents, cuts, leaks, or other signs of damage.
4. Check to make sure all hydraulic hoses are securely fastened to their correct fittings.
5. Check to make sure all hydraulic cylinders pins are secured with correctly installed hitch clips and/or bolts.
6. Grease the Bull Pull hitch.

NOTE: If your Safe-T-Pull ORIGINAL is being used continuously, pre-operation maintenance should be done before EVERY shift change.

Product Maintenance

For proper operation ensure the following equipment is in proper operating condition.

Hydraulic system

- Check hydraulic fluid in the pulling vehicle to make sure levels are adequate.
- Check hydraulic hoses for cuts, cracks, pressure bubbles, or other damage.
NOTE: Steel braiding should NEVER be visible
- Check hydraulic fittings for dents, cuts, leaks, or other signs of damage.
- Check to make sure all hydraulic hoses are securely fastened to their correct fittings.
- Check to make sure all hydraulic cylinders pins are secured with correctly installed hitch clips and/or bolts.

Steel Cable

- Check to make sure the steel cable is in good condition with no cuts, nicks, frays, or other damage.
- Check to make sure all cable clamps are securely tightened and installed correctly.

Centering springs

- Check to make sure both centering springs are securely fastened
- Check to make sure both centering springs are in good physical condition with no cuts, scratches, or scrapes.
- Check to make sure the spring is fully retracted without any tension on them. When the puller arm is resting on the ground no gap should be visible. If any gap is visible your spring has exceeded its maximum weight limit and should be replaced immediately.

Grease

- Grease the Bull Pull hitch.

Replacement Parts

Contact your authorized dealer or manufacturer representative to order replacement parts.

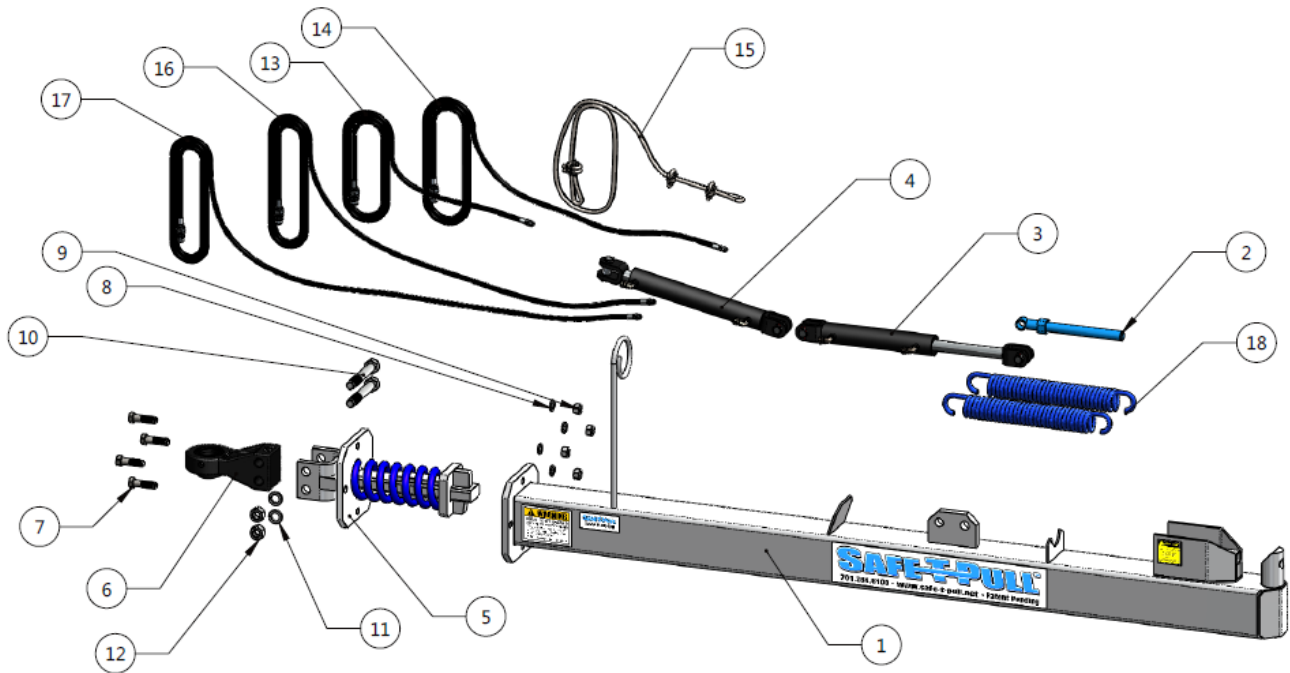

BOM #1
SAFE-T-PULL ORIGINAL PULLER

ITEM NO.	PART NUMBER	DESCRIPTION	QTY.
1	RP-002	STP ORIGINAL PULLER, TUBE WELDMENT	1
2	CP-003	STP COMMON PULLER, LOCKING PIN WELDMENT	1
3	XP-002	STP COMMON PULLER, HITCH PIN LOCKING CYLINDER	1
4	XP-005	STP ORIGINAL PULLER, LIFT CYLINDER	1
5	RP-15009	STP ORIGINAL PULLER, SPRING BULL PULL MOUNT ASSEMBLY	1
6	XP-001	STP ORIGINAL PULLER, BULL PULL	1
7	XP-100	HBOLT 0.7500-10x2.75x1.75	4
8	XP-101	LW 0.75	4
9	XP-102	HNUT 0.7500-10	4
10	XP-103	HBOLT 1.0000-8x7x2.5	2
11	XP-104	LW 1.0	2
12	XP-105	HNUT 1.0000-8	2
13	XP-178	STP COMMON HYDRAULIC HOSE ASSEMBLY - 8' LONG (W/ENDS)	1
14	XP-179	STP COMMON HYDRAULIC HOSE ASSEMBLY - 9' LONG (W/ENDS)	1
15	XP-187	STP ORIGINAL PULLER, SPRING CABLE ASSEMBLY	1
16	XP-180	STP COMMON HYDRAULIC HOSE ASSEMBLY - 10' LONG (W/ENDS)	1
17	XP-181	STP COMMON HYDRAULIC HOSE ASSEMBLY - 11' LONG (W/ENDS)	1
18	XP-169	STP ORIGINAL PULLER, CABLE SPRING - 1500LBS RATED	2

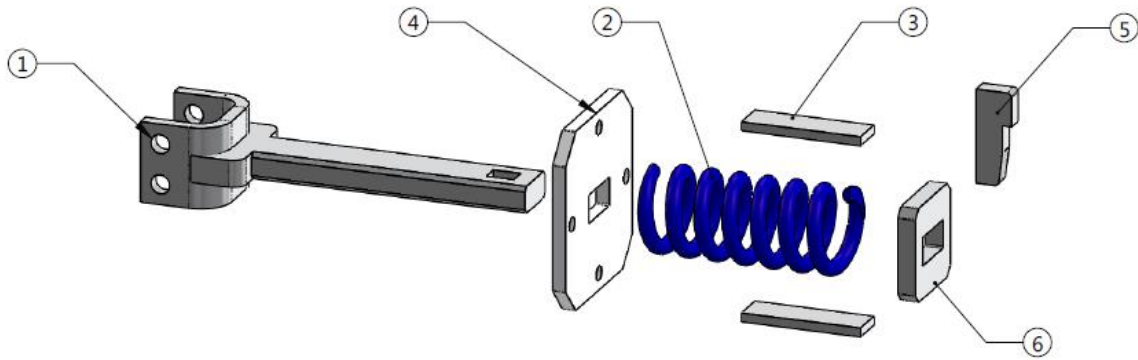

BOM #2
SAFE-T-PULL ORIGINAL PULLER, SPRING BULL PULL MOUNT

ITEM NO.	PART NUMBER	DESCRIPTION	QTY.
1	RP-15003	STP ORIGINAL PULLER, SPRING BULL TONGUE WELDMENT	1
2	XP-114	STP COMMON PULLER, D20 SPRING (353)	1
3	CP-134	STP COMMON PULLER, SPRING STOP PLATE	2
4	CP-15132	STP COMMON PULLER, SPRING TONGUE CAP PLATE	1
5	FP-181	STP PRO PULLER, SPRING KEY (D20 - 353 SPRING)	1
6	CP-15180	STP COMMON PULLER, 353 SPRING BACK PLATE	1

Warning! All stickers should be replaced if worn or unreadable!

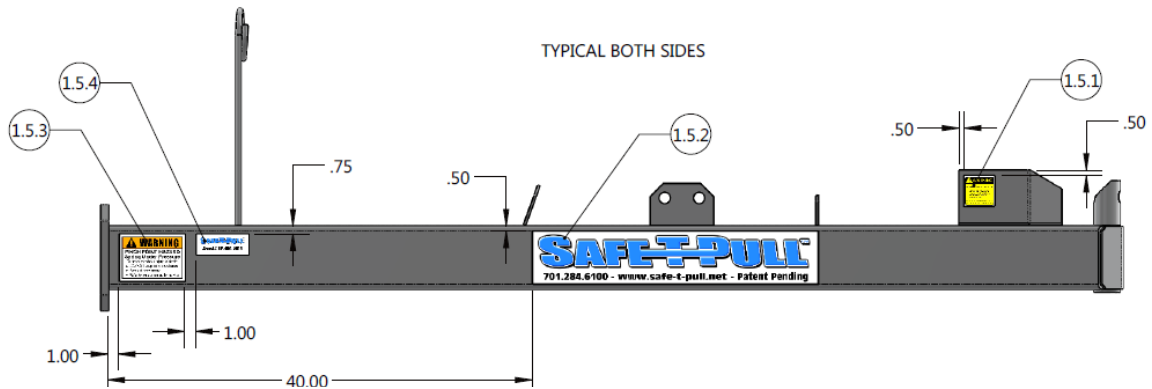

BOM #3
SAFE-T-PULL ORIGINAL PULLER STICKER KIT

ITEM NO.	PART NUMBER	DESCRIPTION	QTY.
1.5.1	XP-290	STP COMMON PULLER, LABEL - MOVING HYD	2
1.5.2	XP-291	STP ORIGINAL PULLER, LABEL - ORIGINAL LABEL	2
1.5.3	XP-292	STP COMMON PULLER, LABEL - PINCH POINT / SPRING	2
1.5.4	XP-293	STP ORIGINAL PULLER, LABEL - SERIAL NUMBER	2