

SAFETY-PULL™ Original

Assembly & Install Guide

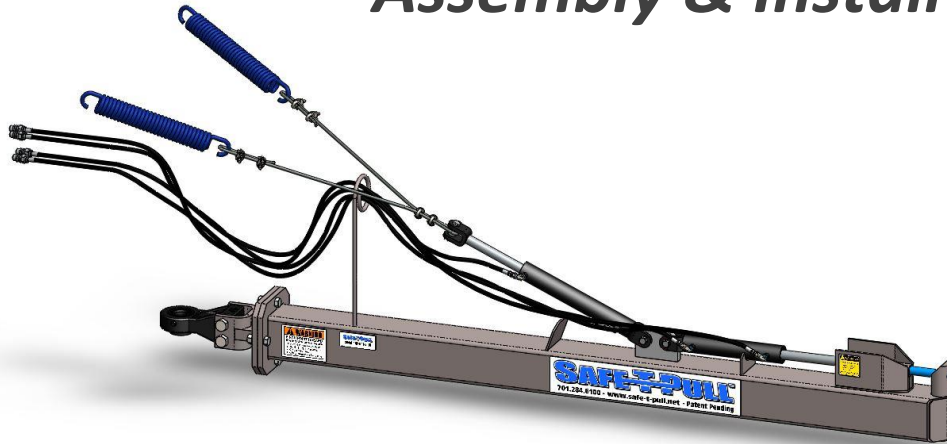

Assembly

If your Safe-T-Pull ORIGINAL has been palletized, assembly is required. After unpacking follow these steps to assembly your Safe-T-Pull ORIGINAL.

Unpacking Instructions

Before discarding any packaging, be sure all included parts are accounted for.

Remove all strapping and/or banding on the package

Assembly Steps:

Slide the tongue assembly into the puller tube assembly and fasten it with four (4) 3/4" bolts, lock washers and nuts. Note: be sure the item isn't upside down. See the diagrams below.

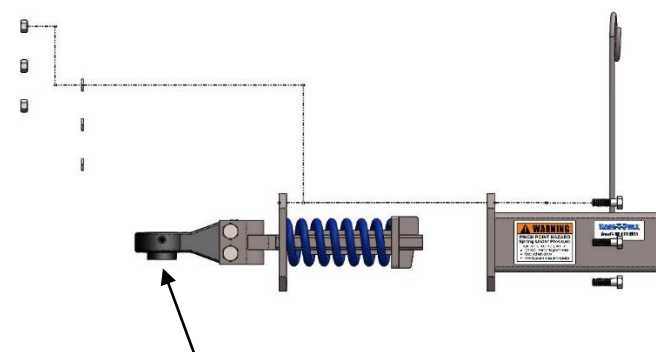
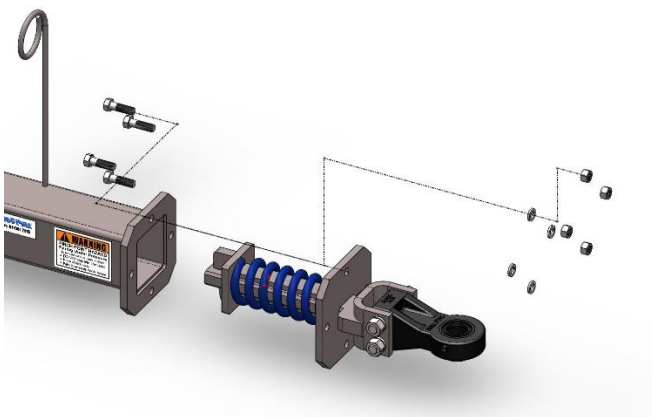

BE SURE THE RING ON THE BULL PULL IS DOWN

Installation

Recommended Tools: Lifting device (fork lift, skid-steer, cherry picker)

WARNING: All equipment must be rated for 1,000 pounds (453.5kg) or more!

Installation Instructions

- Use a lifting device to align the **Bull Pull** of the Safe-T-Pull ORIGINAL between your tractor's drawbar and hammer strap. Slide your tractor's pin into the drawbar and lay the opposite end of the puller straight out from the tractor and let it rest upon the ground.

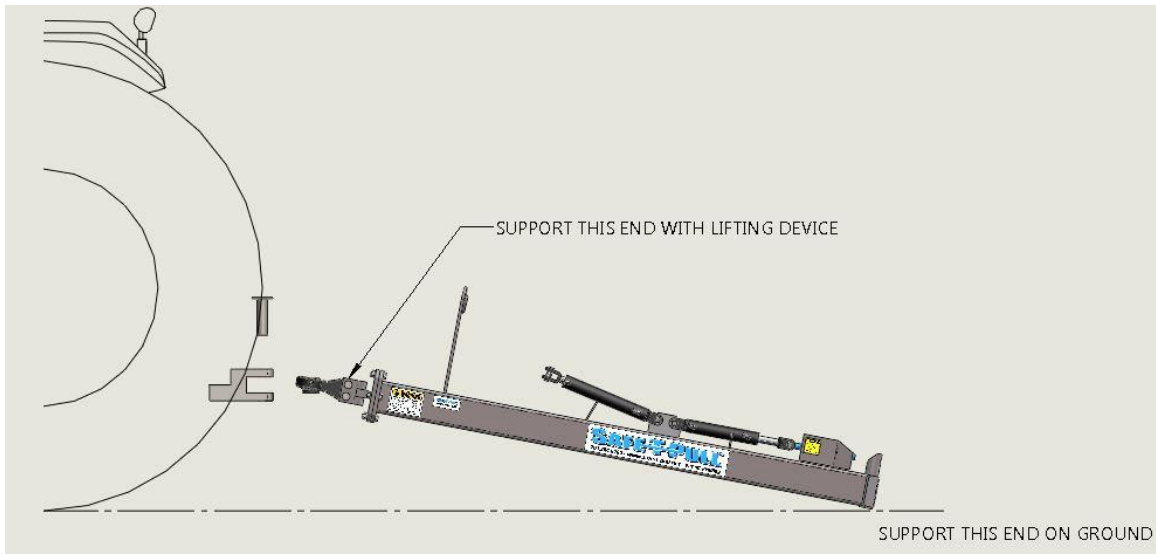

- Push your four (4) hydraulic hoses into your tractor's ports.
 - **CAUTION:** Ensure that all hydraulic equipment is in proper working order. Visit the *Safety Information* section in this document for more information.
- Use your tractor's hydraulics to extend the both cylinders fully. **KEEP OTHERS AWAY!**

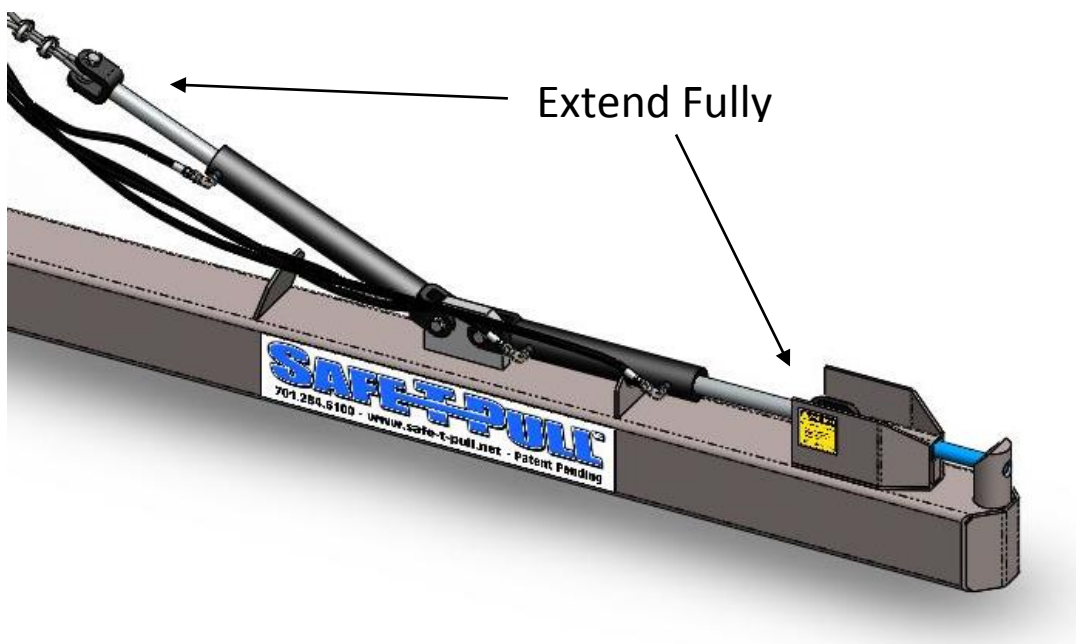

- Attach the two blue centering springs to a sturdy location on your tractor. It is best to install them 3' up and 3' apart from the Safe-T-Pull ORIGINAL tongue. See diagram below
 - NOTE: The top two mounts on a three point hitch work well

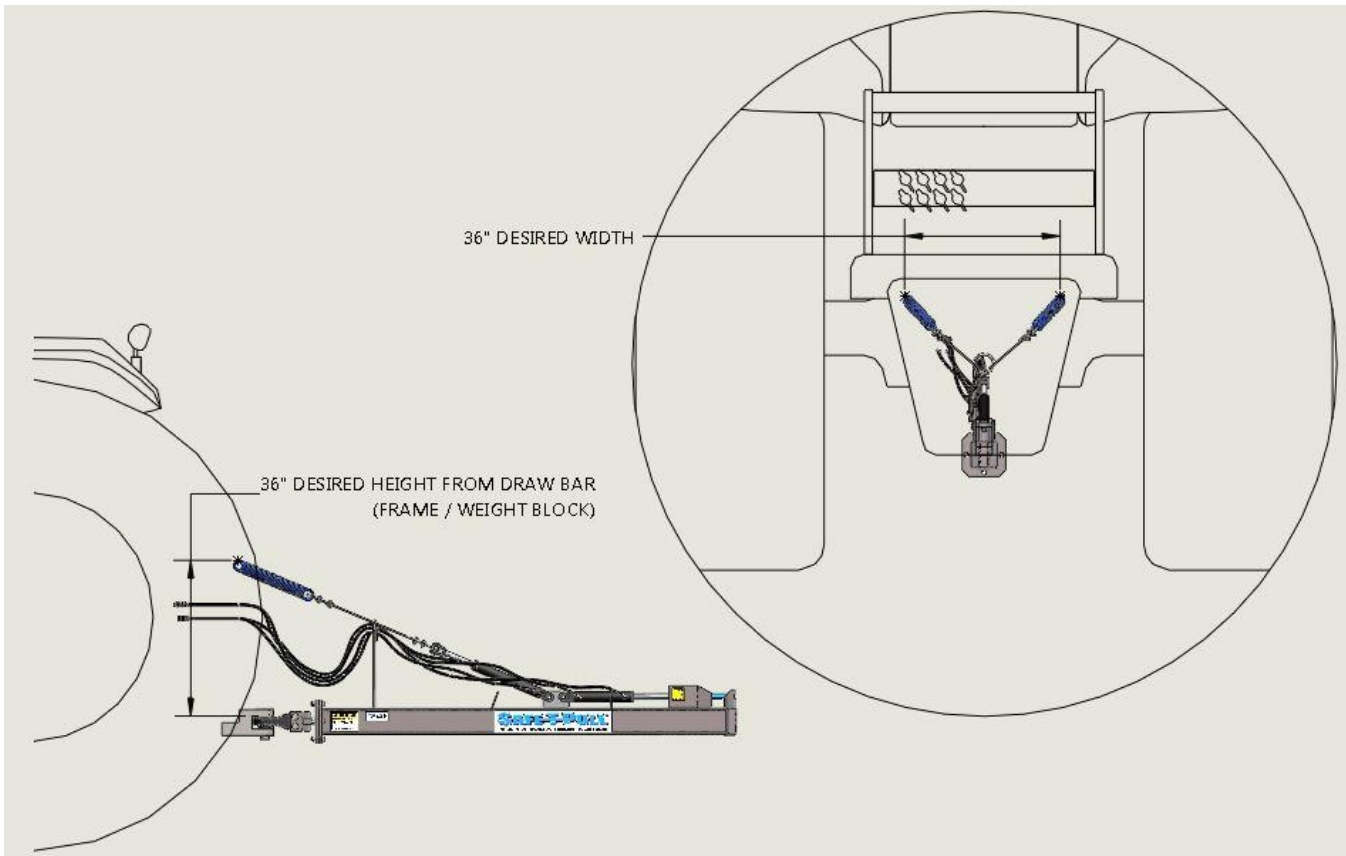

- Attach the two ends of the included steel cable through the centering springs using the included cable clamps. Be sure the cable is tight and even on both sides to ensure proper alignment. (Be sure to install the 'saddle' side onto the live end of the cable)
- Unpin the free end of the lift cylinder and insert the steel cable loop into it. Replace the pin into the lift cylinder.

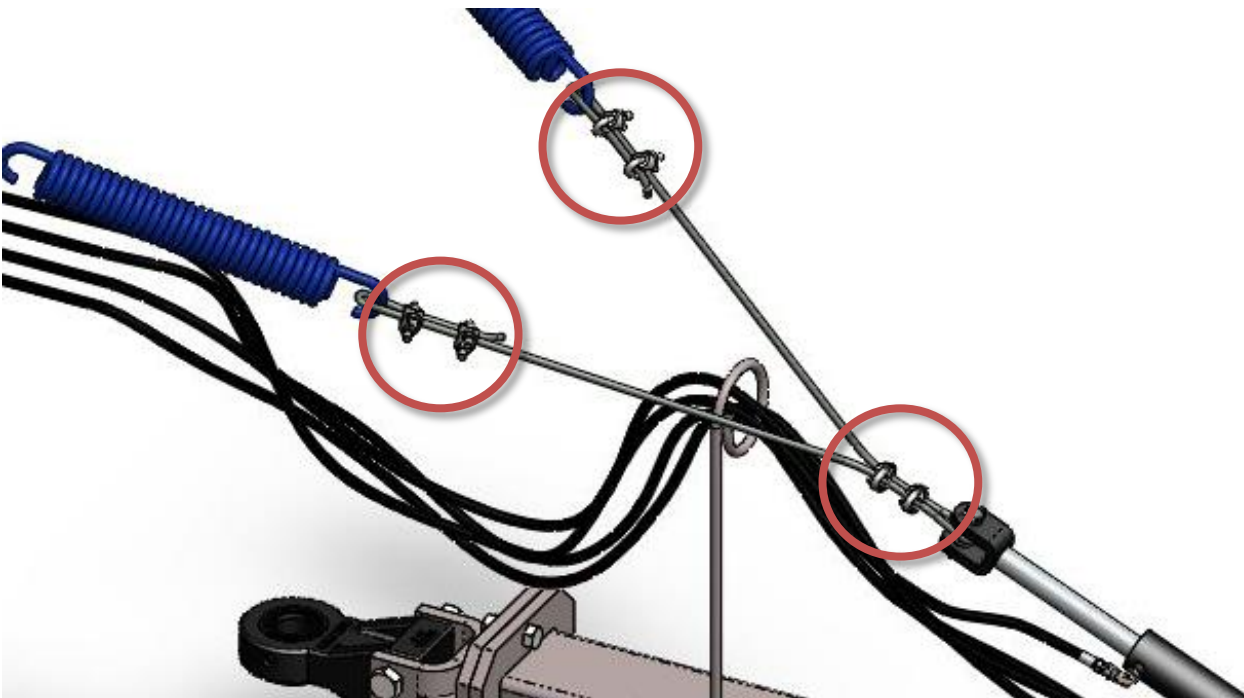

- With all personnel clear, run the hydraulics to be sure the puller is straight off the back of the tractor when raised. If you need to make any adjustments, lower the puller all the way to the ground to relieve all spring pressure before you loosen any clamps.

WARNING: Failure to do so can cause serious injury or even death!

- Raise the puller arm and check to make sure the height of the hook pin is high enough for your application.

WARNING: Keep clear of pinch points when operating. Injury or death may occur.