

# **SAFE-T-PULL™** Original

## *User Manual & Install Guide*

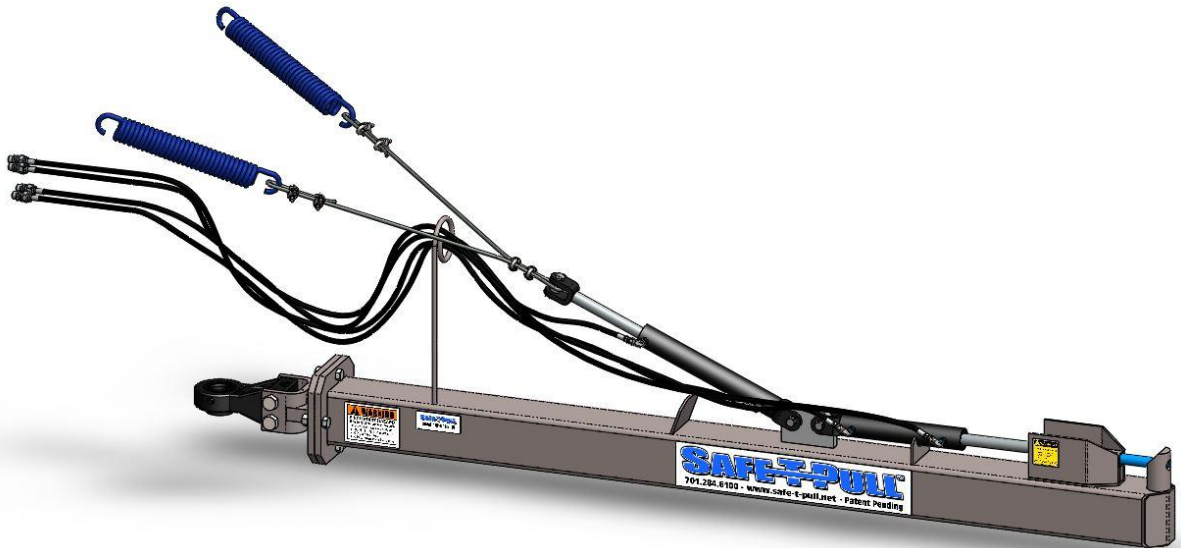

***Safe-T-Pull Inc.***

## TABLE OF CONTENTS

1. Before You Begin.....	3
Disclaimer.....	3
What Is Included.....	3
Claims.....	3
Contact Us.....	4
Safety Notes.....	4
2. Introduction.....	5
Product Dimensions.....	5
3. Setup.....	5
Assembly.....	5
Unpacking Instructions.....	5
Installation.....	5
4. Operation.....	9
Operation Instructions.....	9
5. Technical Information.....	10
Product Maintenance.....	10
6. Technical Specifications.....	11
Specifications.....	11
Replacement Part Numbers.....	12
7. Trouble Shooting and FAQs.....	14

# 1. Before You Begin

## Disclaimer

The information and specifications contained in this document are subject to change without notice. Safe-T-Pull Inc. assumes no responsibility or liability for any errors or omissions that may appear in this manual. Safe-T-Pull Inc. reserves the right to update the existing document or to create a new document to correct any errors or omissions. You can receive the latest version of this document from Safe-T-Pull Inc. by calling your nearest dealer during their business hours.

## What Is Included

- Safe-T-Pull ORIGINAL Puller Tube
- Safe-T-Pull ORIGINAL Bull Pull Tongue
- Two (2) Centering springs



## Claims

If the packaging or the material inside the packaging (the product and included accessories) appear damaged from shipping, or show signs of mishandling, upon receipt notify the carrier immediately, not Safe-T-Pull Inc. Failure to do so in a timely manner may invalidate your claim with the carrier. In addition, keep the container and all the packing material for inspection. For other issues such as missing components or parts, damage not related to shipping, or concealed damage, file a claim with Safe-T-Pull Inc. immediately after receiving the merchandise.

<i>Self-contained hydraulics</i>	<i>No</i>	<i>Vertical Lift</i>	<i>No</i>
<i>Max pulling load*</i>	<i>160,000lbs</i>	<i>Shock absorbing mechanism</i>	<i>Yes</i>
<i>Self-centering mechanism</i>	<i>Springs and Cables</i>	<i>*numbers based off grade 5 hardware</i>	

## **Contact Us**

Email – [sales@safe-t-pull.net](mailto:sales@safe-t-pull.net)

Mail - Safe-T-Pull

P.O. Box 94

Park River, ND 58270

## **Safety Information**

Please read the following Safety Notes carefully before working with the product. The Notes include important safety information about installation, usage, and maintenance.

All personnel working on, with, or near a Safe-T-Pull ORIGINAL must wear safety toed shoes, safety glasses, reflective safety vest, protective gloves, and hard hat.

The Safe-T-Pull ORIGINAL may raise or lower unexpectedly. When servicing the Safe-T-Pull ORIGINAL be sure the pulling vehicle is OFF and the puller arm is in the lowered position.

### **Rules for safe hydraulic operation**

- Park hydraulic machinery where children cannot reach it.
- If your pulling vehicle has hydraulic flow control capabilities, (usually measured in GPM) decrease the flow to 2 GPM. This is the minimum amount to operate a Safe-T-Pull ORIGINAL
- Block the Safe-T-Pull ORIGINAL when you must work on the system while raised; do not rely solely on the hydraulic lift.
- Avoid servicing the hydraulic system while the machine engine is running.
- Do not remove cylinders until the Safe-T-Pull ORIGINAL is resting on the ground or securely on safety stands or blocks; shut off engine.
- Before disconnecting hydraulic hoses, relieve all hydraulic pressure.
- Be sure all hose connections are tight and hoses are not damaged.
- Use a non-volatile cleaning solvent to wash parts.

### **Three common hydraulic system hazards**

1. Burns from very hot, high pressure fluid.
2. Injuries and illness from flailing hydraulic lines.
3. Hydraulic fluid injection into the body.

### **Ways to prevent hazards from occurring**

- When attempting to detect pinhole leaks in hydraulic hoses run a piece of cardboard or wood along the hose.
- NEVER touch hydraulic hoses when they are under pressure.
- Never connect a low pressure hose, cylinder, or other aftermarket equipment to the Safe-T-Pull ORIGINAL.
- Ensure all hydraulic components are in proper working condition on the pulling vehicle.
- Periodically check for oil leaks and worn hoses.
- Keep contaminants from hydraulic oil and replace filters regularly.
- Lubricate cylinder rods with protective lubricant to avoid rusting.

## 2. Introduction

### Product Dimensions

Length – 9' 4"

Width – 10"

Height – 2' 5"

Weight – 393lbs

## 3. Setup

### Assembly

If your Safe-T-Pull ORIGINAL has been palletized, assembly is required. After unpacking follow these steps to assembly your Safe-T-Pull ORIGINAL.

### Unpacking Instructions

Before discarding any packaging, be sure all included parts are accounted for.

Remove all strapping and/or banding on the package

### Assembly Steps:

Slide the tongue assembly into the puller tube assembly and fasten it with four (4)  $\frac{3}{4}$ " bolts, lock washers and nuts. Note: be sure the item isn't upside down. See the diagrams below.

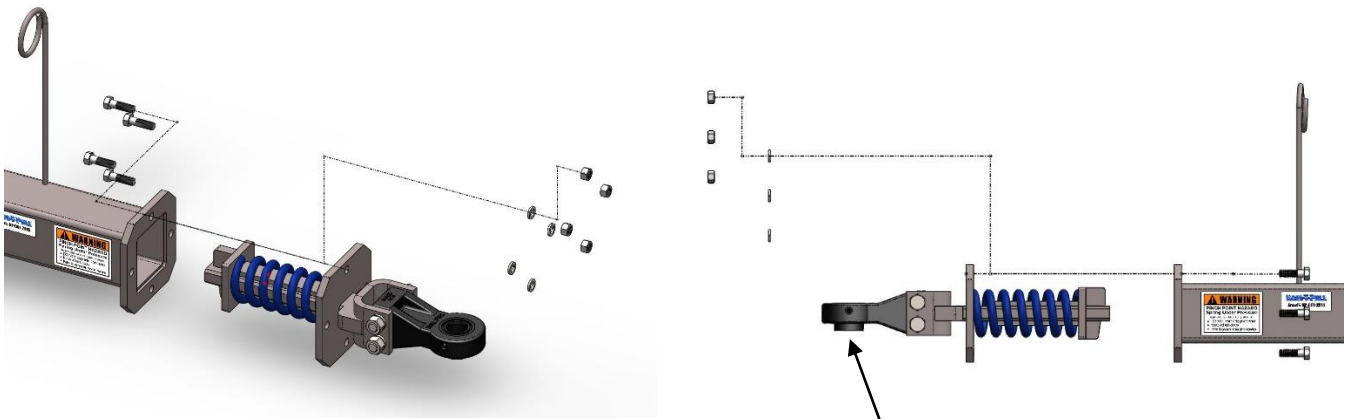

### Installation

Recommended Tools: Lifting device (fork lift, skid-steer, cherry picker)

**WARNING: All equipment must be rated for 1,000 pounds (453.5kg) or more!**

## Installation Instructions

- Use a lifting device to align the **Bull Pull** of the Safe-T-Pull ORIGINAL between your tractor's drawbar and hammer strap. Slide your tractor's pin into the drawbar and lay the opposite end of the puller straight out from the tractor and let it rest upon the ground.

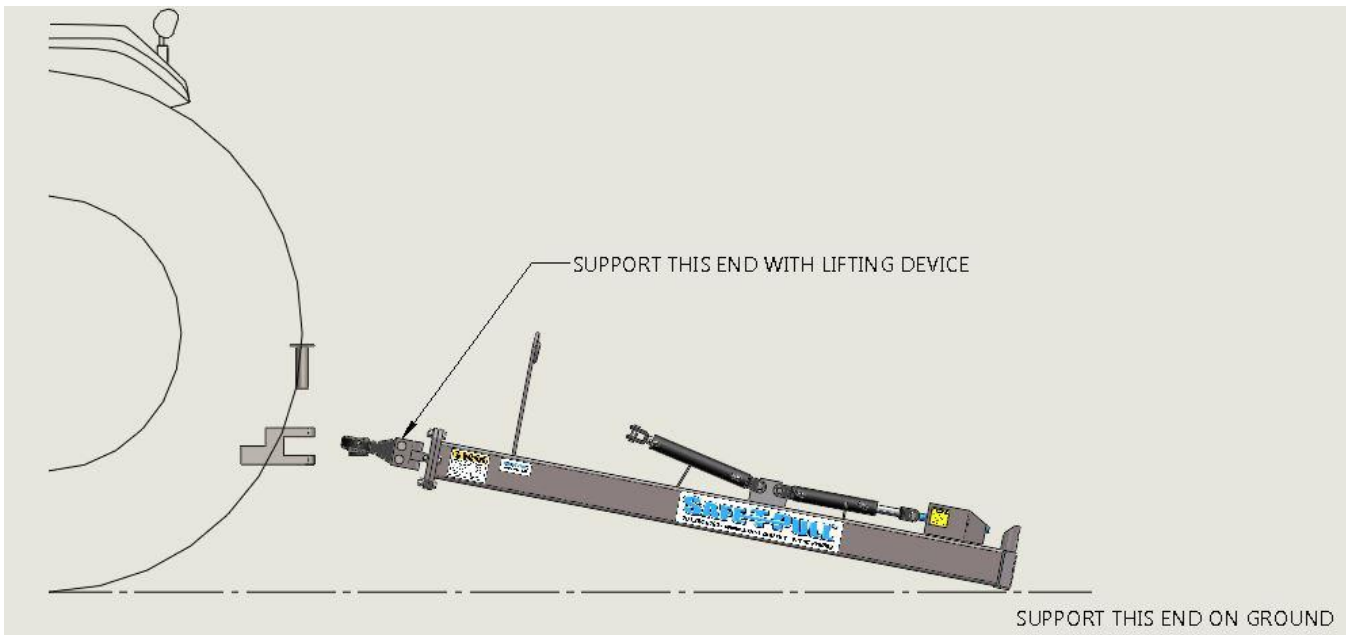

- Push your four (4) hydraulic hoses into your tractor's ports.
  - **CAUTION:** Ensure that all hydraulic equipment is in proper working order. Visit the *Safety Information* section in this document for more information.
- Use your tractor's hydraulics to extend the both cylinders fully. **KEEP OTHERS AWAY!**

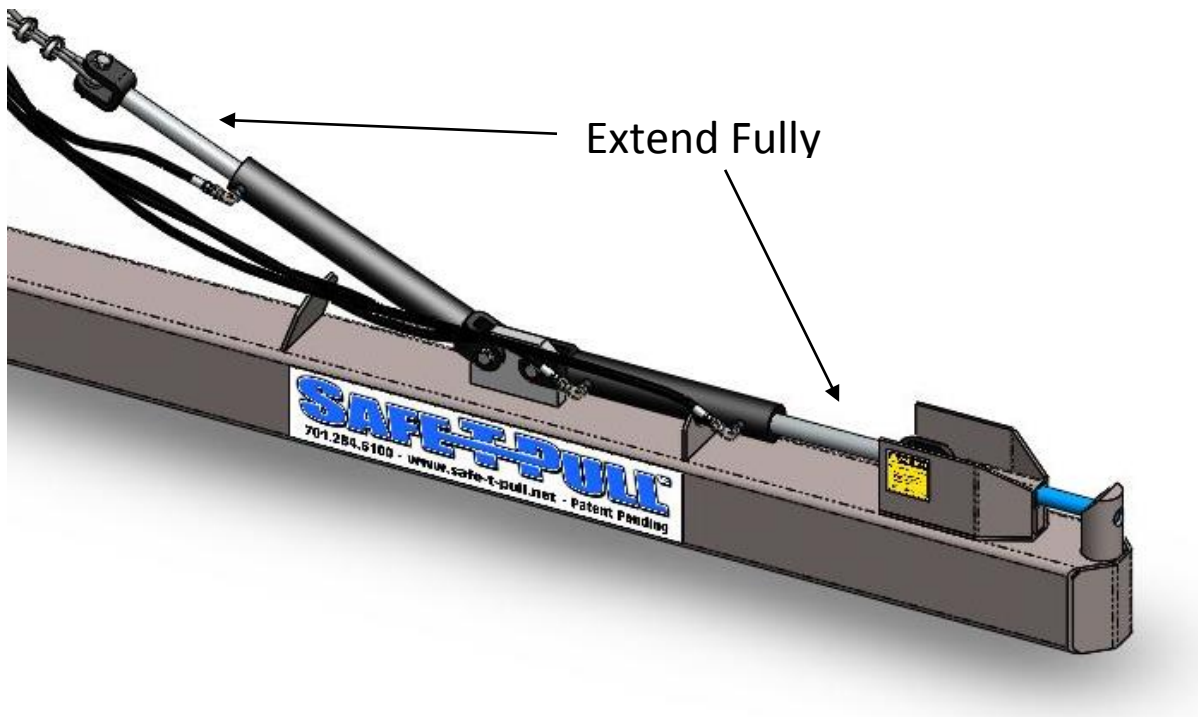

- Attach the two blue centering springs to a sturdy location on your tractor. It is best to install them 3' up and 3' apart from the Safe-T-Pull ORIGINAL tongue. See diagram below
  - NOTE: The top two mounts on a three point hitch work well

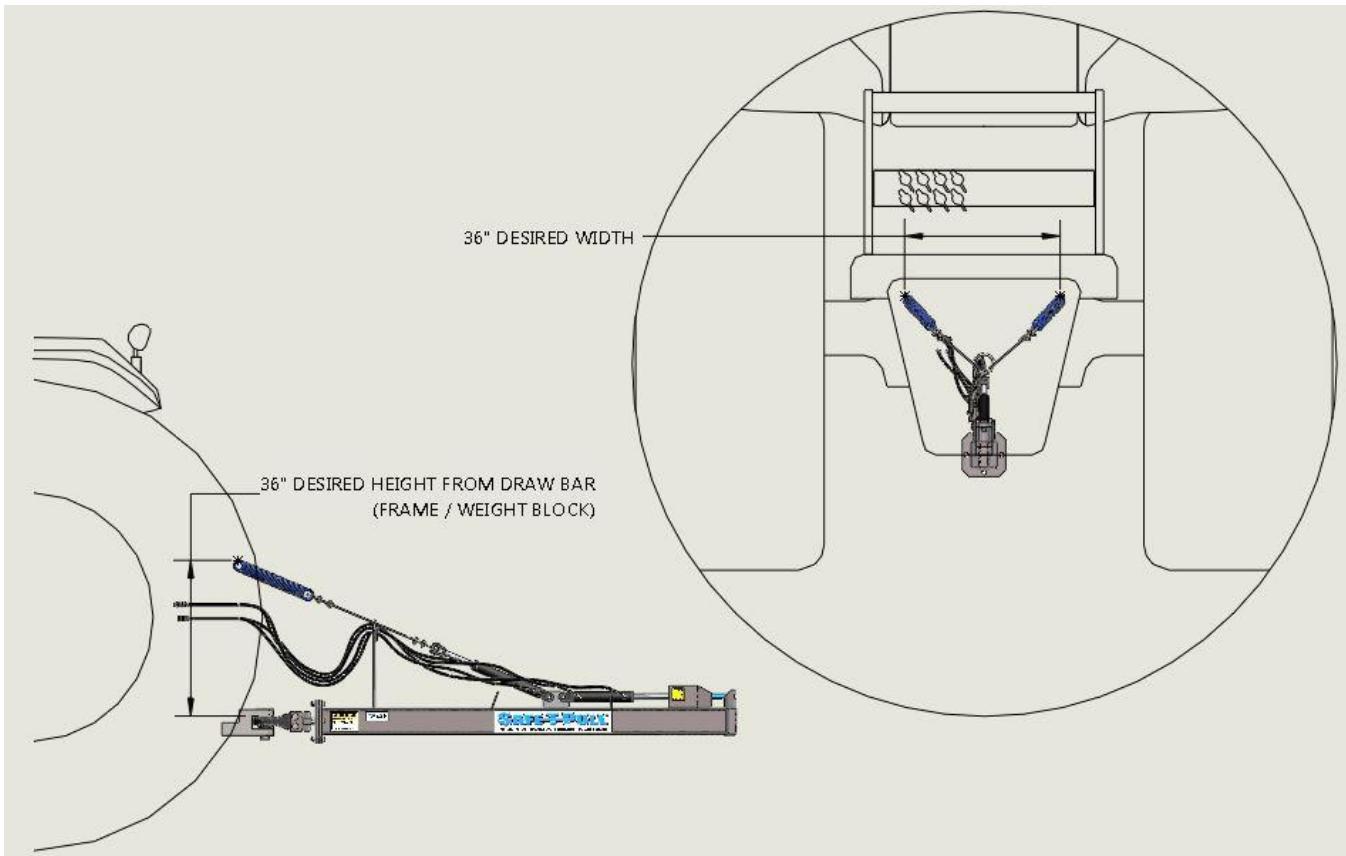

- Attach the two ends of the included steel cable through the centering springs using the included cable clamps. Be sure the cable is tight and even on both sides to ensure proper alignment. (Be sure to install the 'saddle' side onto the live end of the cable)
- Unpin the free end of the lift cylinder and insert the steel cable loop into it. Replace the pin into the lift cylinder.

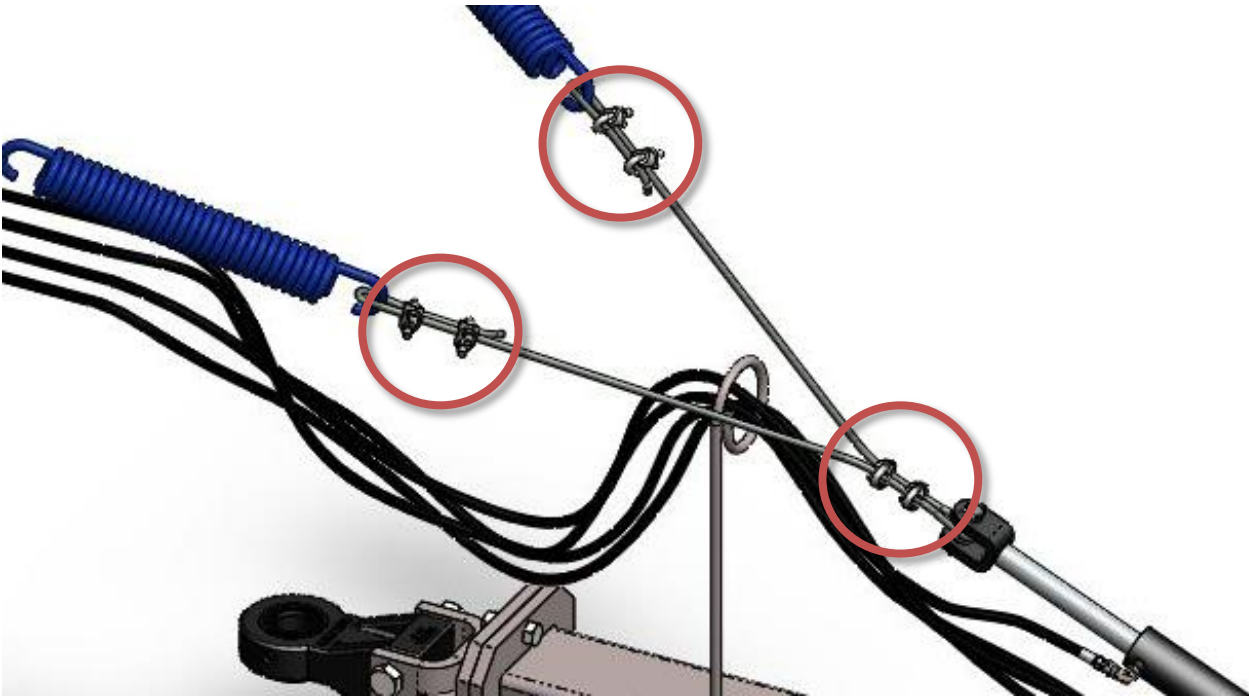

- With all personnel clear, run the hydraulics to be sure the puller is straight off the back of the tractor when raised. If you need to make any adjustments, lower the puller all the way to the ground to relieve all spring pressure before you loosen any clamps.  
**WARNING: Failure to do so can cause serious injury or even death!**
- Raise the puller arm and check to make sure the height of the hook pin is high enough for your application.  
**WARNING: Keep clear of pinch points when operating. Injury or death may occur.**



## 4. Operation Instructions

### *Pre-Operation Maintenance*

Before every operation of your Safe-T-Pull ORIGINAL an inspection and pre-operation maintenance should be done to ensure all components are in operating order:

1. Check hydraulic fluid in the pulling vehicle to make sure levels are adequate.
2. Check hydraulic hoses for cuts, cracks, pressure bubbles, or other damage.  
*NOTE:* Steel braiding should NEVER be visible
3. Check hydraulic fittings for dents, cuts, leaks, or other signs of damage.
4. Check to make sure all hydraulic hoses are securely fastened to their correct fittings.
5. Check to make sure all hydraulic cylinders pins are secured with correctly installed hitch clips and/or bolts.
6. Grease the Bull Pull hitch.

**NOTE:** If your Safe-T-Pull ORIGINAL is being used continuously, pre-operation maintenance should be done before EVERY shift change.

### *Operation Instructions*

#### *Hooking up:*

- Be sure ALL persons are clear of the operating area.
- With the Safe-T-Pull ORIGINAL arm in the lowered position, back the pulling vehicle up to the stuck vehicle. (A decrease in engine RPMs may be necessary for more precise control)
- Once the Safe-T-Pull ORIGINAL's hook pin is directly under the Safe-T-Pull Truck Hitch pulling loop, raise the Safe-T-Pull ORIGINAL up (retract the lift cylinder) and into the Truck Hitch pulling loop.
- **WARNING:** For your safety NEVER use the Safe-T-Pull ORIGINAL for pulling on unauthorized products.
- Close the Pin (extend the Pin Cylinder) to lock in the Truck Hitch.
- Lower the Safe-T-Pull ORIGINAL so that the springs are not under tension.
- **WARNING:** Leaving the puller arm raised while pulling may damage your centering springs.
- Remove the downed vehicle from its location to a suitable location.

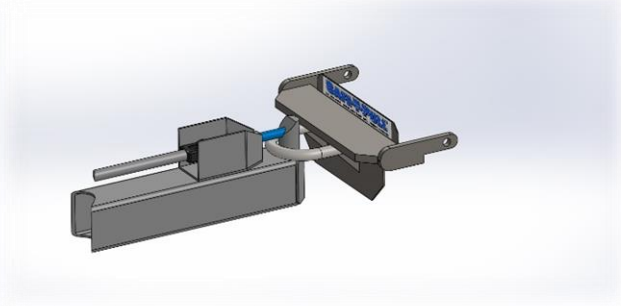
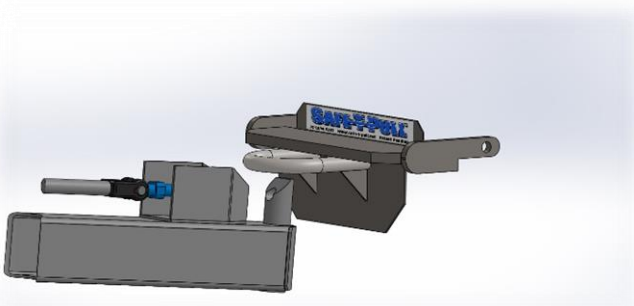

**To hook up, back the Safe-T-Pull Pro under the Truck Hitch. Lift the puller arm into the hitch loop and close the latch pin.**

### **Unhooking:**

- Open the lock pin (retract the Pin Cylinder)
- Lower the Safe-T-Pull ORIGINAL (extend the lift cylinder). If there is tension between the hook pin of the puller and pulling loop of the Truck Hitch, the puller may not lower. In this case a decrease in ground speed by the pulling vehicle may be required to free the pulling arm from the Truck Hitch.
- Once the Safe-T-Pull ORIGINAL is clear of the Truck Hitch, raise the pulling arm up (retract the lift cylinder) to keep it from dragging on the ground.

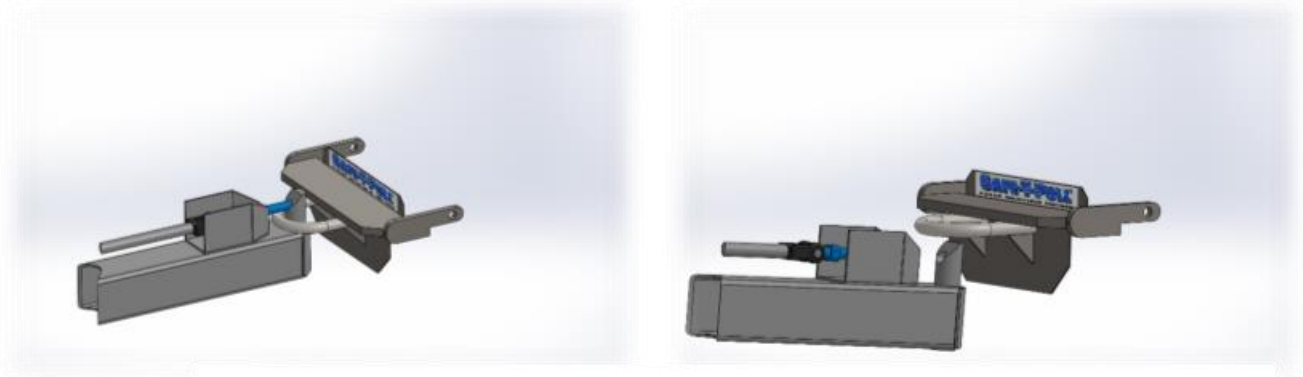

**To unhook, open the latch pin, lower the puller arm, and drive away.**

**NOTE: Your warranty will be void if you use a Safe-T-Pull Original with unauthorized products.**

## **5. Technical Information**

### **Product Maintenance**

For proper operation ensure the following equipment is in proper operating condition.

#### **Hydraulic system**

- Check hydraulic fluid in the pulling vehicle to make sure levels are adequate.
- Check hydraulic hoses for cuts, cracks, pressure bubbles, or other damage.  
*NOTE: Steel braiding should NEVER be visible*
- Check hydraulic fittings for dents, cuts, leaks, or other signs of damage.
- Check to make sure all hydraulic hoses are securely fastened to their correct fittings.
- Check to make sure all hydraulic cylinders pins are secured with correctly installed hitch clips and/or bolts.

#### **Steel Cable**

- Check to make sure the steel cable is in good condition with no cuts, nicks, frays, or other damage.
- Check to make sure all cable clamps are securely tightened and installed correctly.

### ***Centering springs***

- Check to make sure both centering springs are securely fastened
- Check to make sure both centering springs are in good physical condition with no cuts, scratches, or scrapes.
- Check to make sure the spring is fully retracted without any tension on them. When the puller arm is resting on the ground no gap should be visible. If any gap is visible your spring has exceeded its maximum weight limit and should be replaced immediately.

### ***Grease***

- Grease the Bull Pull hitch.

## ***6. Technical Specifications***

### ***Specifications***

*Dimensions – Length: 9'4" Width: 10" Height: 2'5"*

*Weight – 383lbs*

*Hydraulic Power Source – Pull vehicle*

*System Voltage – N/A*

*Max psi – 3000 psi*

## Replacement Parts

Contact your authorized dealer or manufacturer representative to order replacement parts.

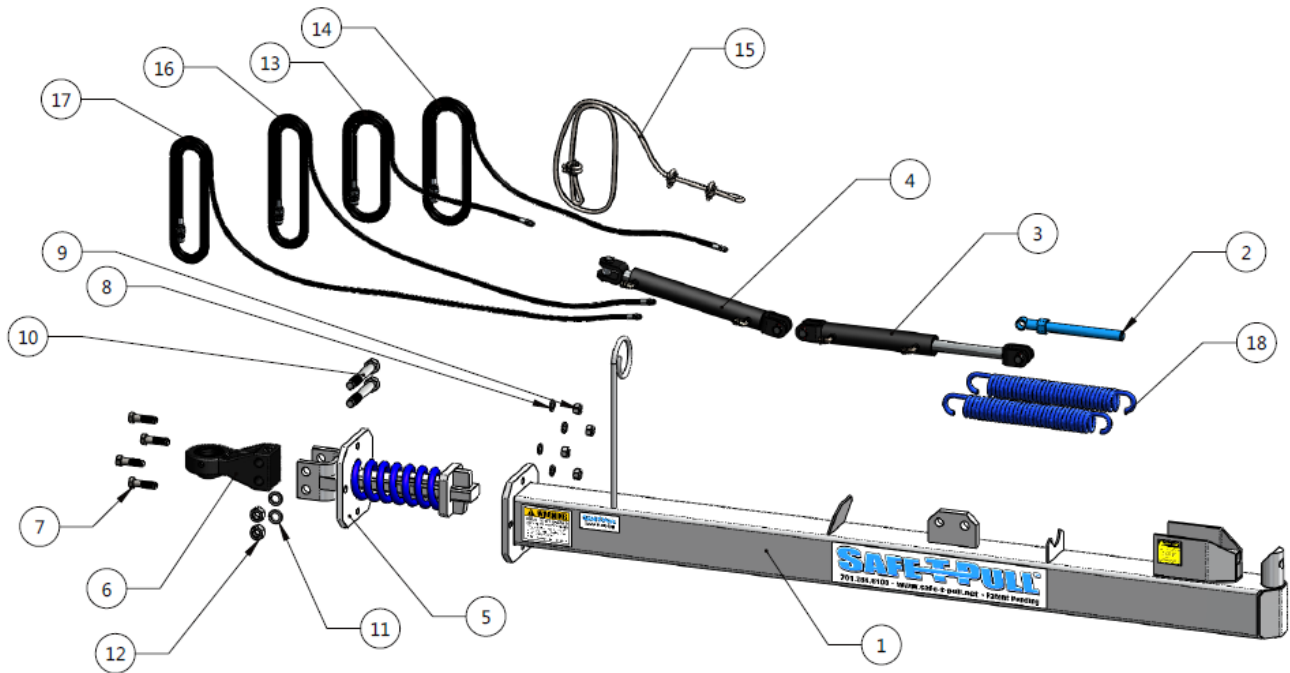

**BOM #1**  
SAFE-T-PULL ORIGINAL PULLER

ITEM NO.	PART NUMBER	DESCRIPTION	QTY.
1	RP-002	STP ORIGINAL PULLER, TUBE WELDMENT	1
2	CP-003	STP COMMON PULLER, LOCKING PIN WELDMENT	1
3	XP-002	STP COMMON PULLER, HITCH PIN LOCKING CYLINDER	1
4	XP-005	STP ORIGINAL PULLER, LIFT CYLINDER	1
5	RP-15009	STP ORIGINAL PULLER, SPRING BULL PULL MOUNT ASSEMBLY	1
6	XP-001	STP ORIGINAL PULLER, BULL PULL	1
7	XP-100	HBOLT 0.7500-10x2.75x1.75	4
8	XP-101	LW 0.75	4
9	XP-102	HNUT 0.7500-10	4
10	XP-103	HBOLT 1.0000-8x7x2.5	2
11	XP-104	LW 1.0	2
12	XP-105	HNUT 1.0000-8	2
13	XP-178	STP COMMON HYDRAULIC HOSE ASSEMBLY - 8' LONG (W/ENDS)	1
14	XP-179	STP COMMON HYDRAULIC HOSE ASSEMBLY - 9' LONG (W/ENDS)	1
15	XP-187	STP ORIGINAL PULLER, SPRING CABLE ASSEMBLY	1
16	XP-180	STP COMMON HYDRAULIC HOSE ASSEMBLY - 10' LONG (W/ENDS)	1
17	XP-181	STP COMMON HYDRAULIC HOSE ASSEMBLY - 11' LONG (W/ENDS)	1
18	XP-169	STP ORIGINAL PULLER, CABLE SPRING - 1500LBS RATED	2

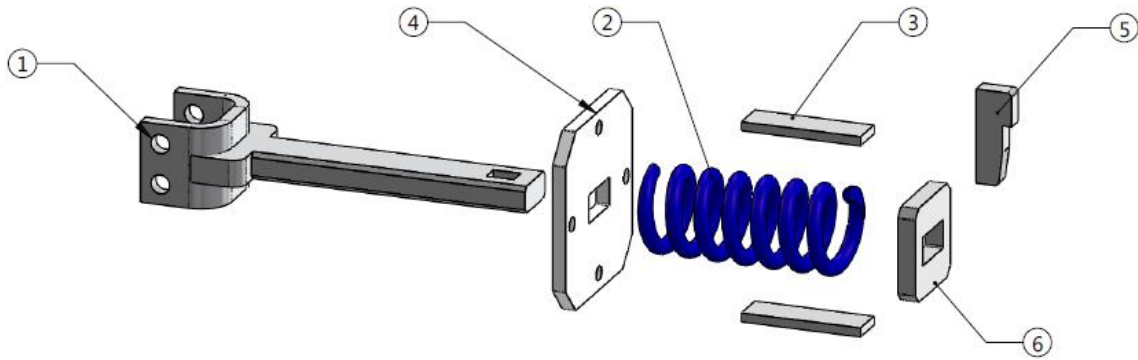

**BOM #2**  
SAFE-T-PULL ORIGINAL PULLER, SPRING BULL PULL MOUNT

ITEM NO.	PART NUMBER	DESCRIPTION	QTY.
1	RP-15003	STP ORIGINAL PULLER, SPRING BULL TONGUE WELDMENT	1
2	XP-114	STP COMMON PULLER, D20 SPRING (353)	1
3	CP-134	STP COMMON PULLER, SPRING STOP PLATE	2
4	CP-15132	STP COMMON PULLER, SPRING TONGUE CAP PLATE	1
5	FP-181	STP PRO PULLER, SPRING KEY (D20 - 353 SPRING)	1
6	CP-15180	STP COMMON PULLER, 353 SPRING BACK PLATE	1

**Warning! All stickers should be replaced if worn or unreadable!**

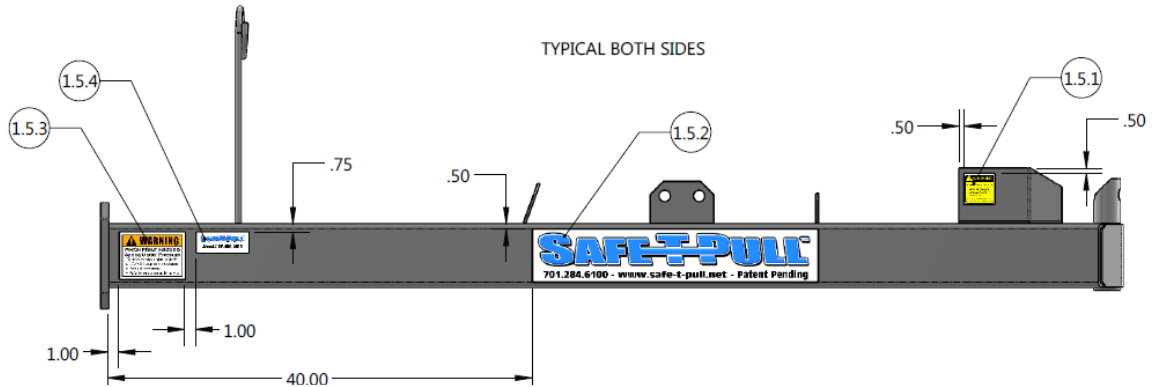

**BOM #3**  
SAFE-T-PULL ORIGINAL PULLER STICKER KIT

ITEM NO.	PART NUMBER	DESCRIPTION	QTY.
1.5.1	XP-290	STP COMMON PULLER, LABEL - MOVING HYD	2
1.5.2	XP-291	STP ORIGINAL PULLER, LABEL - ORIGINAL LABEL	2
1.5.3	XP-292	STP COMMON PULLER, LABEL - PINCH POINT / SPRING	2
1.5.4	XP-293	STP ORIGINAL PULLER, LABEL - SERIAL NUMBER	2

## 7. Troubleshooting and FAQs

### 1) Does the Safe-T-Pull ORIGINAL come with everything I need to use it?

Yes, all Safe-T-Pull products come ready for use. On the hydraulic hoses, we install ½” pioneer fittings for quick coupling. All the required fasteners, hardware, and hydraulic lines are included.

*NOTE:* Hydraulic lines will be empty when you receive your Safe-T-Pull ORIGINAL. Fill lines before use.

### 2) What tools will I need to install the Safe-T-Pull ORIGINAL?

#### *Recommended tools*

- Lifting device (fork lift, skid-steer, cherry picker)
- Rubber mallet/Sand hammer
- 9/16” wrench

**WARNING:** All lifting equipment must be rated for 1,000 pounds (453.5kg) or more!

### 3) How do I hook up the Safe-T-Pull ORIGINAL to the tractor?

- Use a lifting device to align the tongue of the Safe-T-Pull ORIGINAL into your tractor’s drawbar
- Slide your tractor’s pin into the drawbar (a rubber mallet/sand hammer may be needed)
- Push your four (4) hydraulic hoses into your tractor’s ports.
  - **CAUTION:** Ensure that all hydraulic equipment is in proper working order. Visit the *Safety Information* section in this document for more information.
- Use your tractor’s hydraulics to extend the lift cylinder
- Attach the two included centering springs to a sturdy location on your tractor.
  - *NOTE:* The top two mounts on a three point hitch work well
- Attach the two ends of the included steel cable to the centering springs using the included cable clamps.
- Unpin the free end of the lift cylinder and insert the steel cable into it. Replace the pin into the lift cylinder.
- With the puller arm still lowered adjust the slack in the steel cable until it becomes taught.
- Be sure to keep hoses and personnel away from all pinch points during operation.
- Follow all guidelines covered in the *Safety Information* section of this document.

### 4) My draw bar is only 3” wide with a 1 ½” pin; will the Safe-T-Pull ORIGINAL work?

Yes, you will have to use a bushing on your pin to avoid unnecessary wear.

**5) My draw bar is 5" wide with 2 3/4" pin; will the Safe-T-Pull ORIGINAL work?**

Yes, you will have to use a 2" pin and use bushings on your drawbar.

**6) How long should I expect my Safe-T-Pull ORIGINAL to last?**

Forever! The first Safe-T-Pulls are over 20 years old and are still in use. Depending on how well your Safe-T-Pull ORIGINAL is cared for and how often it is used, very few parts will need to be replaced. Some replacement parts will wear out faster than others.

**7) Is there something to cushion the pull?**

The Safe-T-Pull™ has a shock absorbing compression spring built into the internals of the pulling arm. This technology allows the puller to flex and absorb the "jerk" upon take off, acting like a nylon rope without the dangers and limitations.

**8) Can I order replacement parts if something were to wear out?**

Yes. Please contact your local dealer or manufacturer representative for ordering your replacement parts. Most of our parts are made in-house and are in stock.

**9) How soon can I expect my Safe-T-Pull ORIGINAL?**

Once the order has been placed with your dealer or manufacturer representative, we will do our best to get your product to you as quickly as possible. Most of our orders will ship same-day. However, during our busy season (September thru November) production may be backed up by over two weeks. To avoid any delays it is best to place orders early.

**NOTE: Freight shipments to some parts of the country may take up to a week or more.**

**10) How soon can I expect my Safe-T-Pull replacement parts?**

Once the order has been placed with your dealer or manufacturer representative, we will do our best to get your product to you as quickly as possible. All of our replacement parts are in stock and will usually be shipped same-day. There is a risk of parts being out of stock during our busy season (September thru November). To avoid any delays it is best to place orders early.

**NOTE: Freight shipments to some parts of the country may take up to a week or more.**